

3-V-2480-03010R/01  
DRAWING NO.

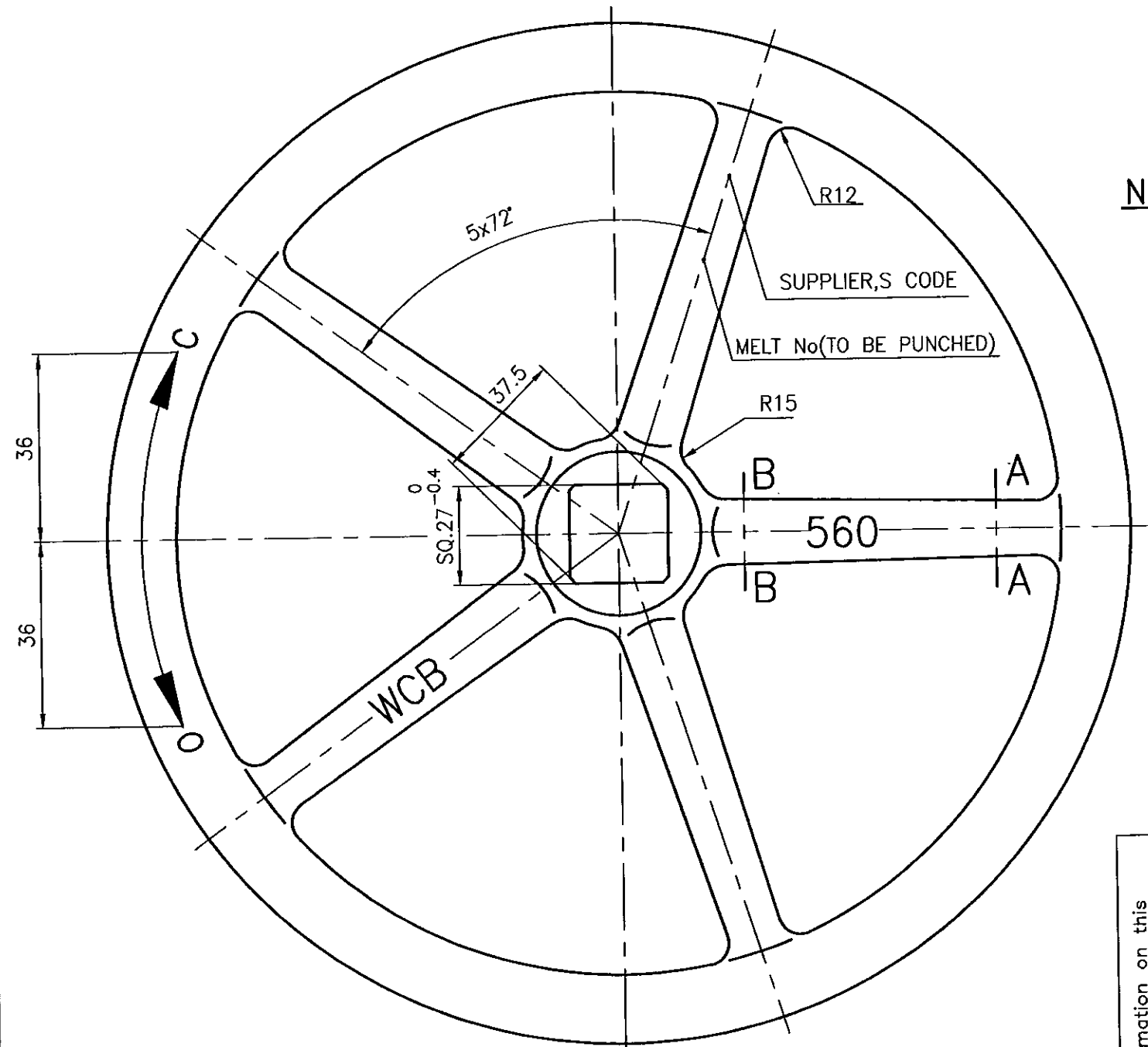
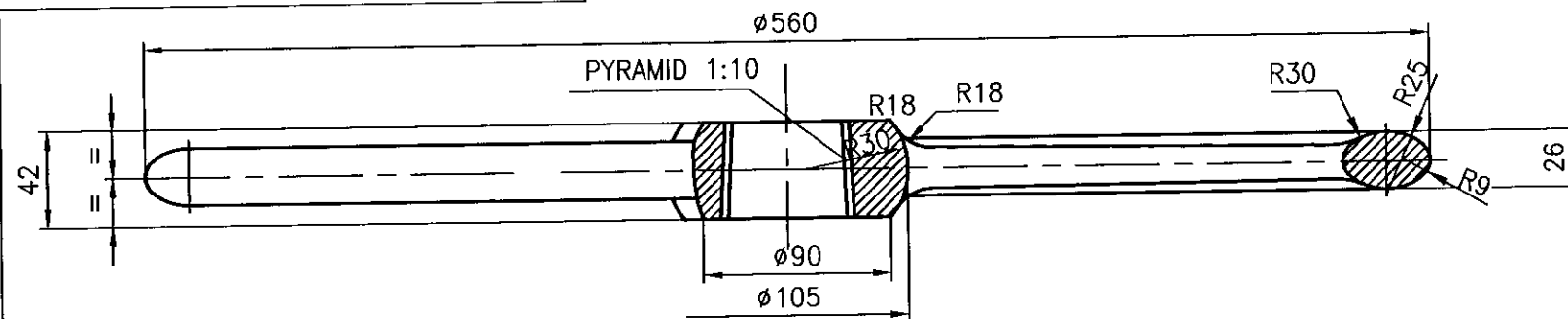

**NOTE:-**

1. CASTING SHALL COMPLY WITH REQUIREMENT OF APPLICABLE QUALITY PROCEDURE.
2. ALL SURFACES MUST BE OF HIGH QUALITY WITH OUT SURFACE UNEVENNESS.
3. HEIGHT OF CAST LETTERS 12 MM.
4. \* TOLERANCE TO BE MAINTAINED IN THE FINISHED HAND WHEEL MAINTAINED BY FILING THE PYRAMIDAL HOLE NEATLY.
5. MATERIAL MARK, HAND WHEEL SIZE 560, OPENING & CLOSING MARK "O" & "C" AND THE ARROW MARKS ARE TO BE CAST.

**SECTION-AA**

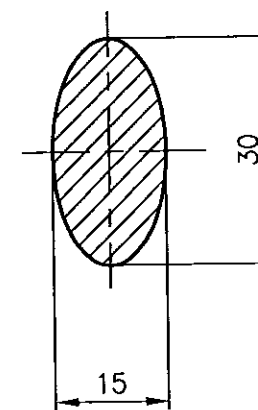

**SECTION-BB**

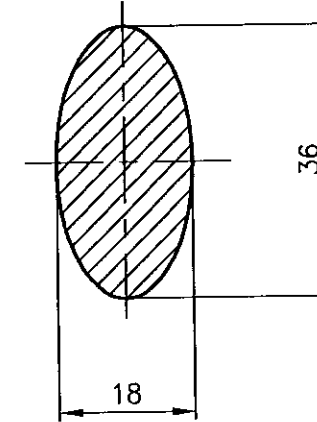

NO	CASTING	92 010 087	A216 WCB CERTIFY	NR	10		14.0		
OFF	DESCRIPTION	MATL CODE	MATL SPECN	HEAT TREATMENT	SCRAP SORT	NET WT (kg)	GROSS WT (kg)	DRAWING No	ITEM No
TYPE OF PRODUCT OR NAME OF CUSTOMER/PROJECT									
CS									
BHARAT HEAVY ELECTRICALS LTD., UNIT: HIGH PRESSURE BOILER PLANT. TIRUCHIRAPALLI-620014.				DRN	NAME	SIGN	DATE	NO. OF VAR.	
365-121				CHD	N.DHANAPAL		20.06.97		
				APPD	A.V.NATHAN		20.06.97		
DEPT	VL	SCALE	WEIGHT (KG).	REFERENCE INFORMATION			NO. OF ITEMS		
CODE	320	NTS	-	CAD.CODE.C303010R					
TITLE				CARD CODE	DRAWING NO.				REV
HAND WHEEL Ø560				U 01	3-V-2480-03010R/01				01

REV 01 DATE 23.06.97 ALTERED T.L. CHD & APPD  
MATL SPECN IS 2108 Gr.A CHANGED AS A216 WCB  
REFER DCN CS: 0718

CAUTION: The information on this document is the property of BHARAT HEAVY ELECTRICALS LTD. It must not be used directly or indirectly in any way detrimental to the interest of the company.